



QDC-HOS

QDC HOSE ADAPTER

January 28, 2008



QDC-HOS ADAPTER ASSEMBLY

(Part Number: 410786)

**CONVERSION KIT FOR OLDER
SUPPLY/SYSTEM HOSES
FITTED WITH CGA-680
CONNECTORS
TYPICALLY
FOUND ON THE
FOLLOWING:**

- **MANCS,**
- **NBK-1, -2, -3**
- **NDSK-4,**
- **LPSK-2A**
- **& HPSK-2A**

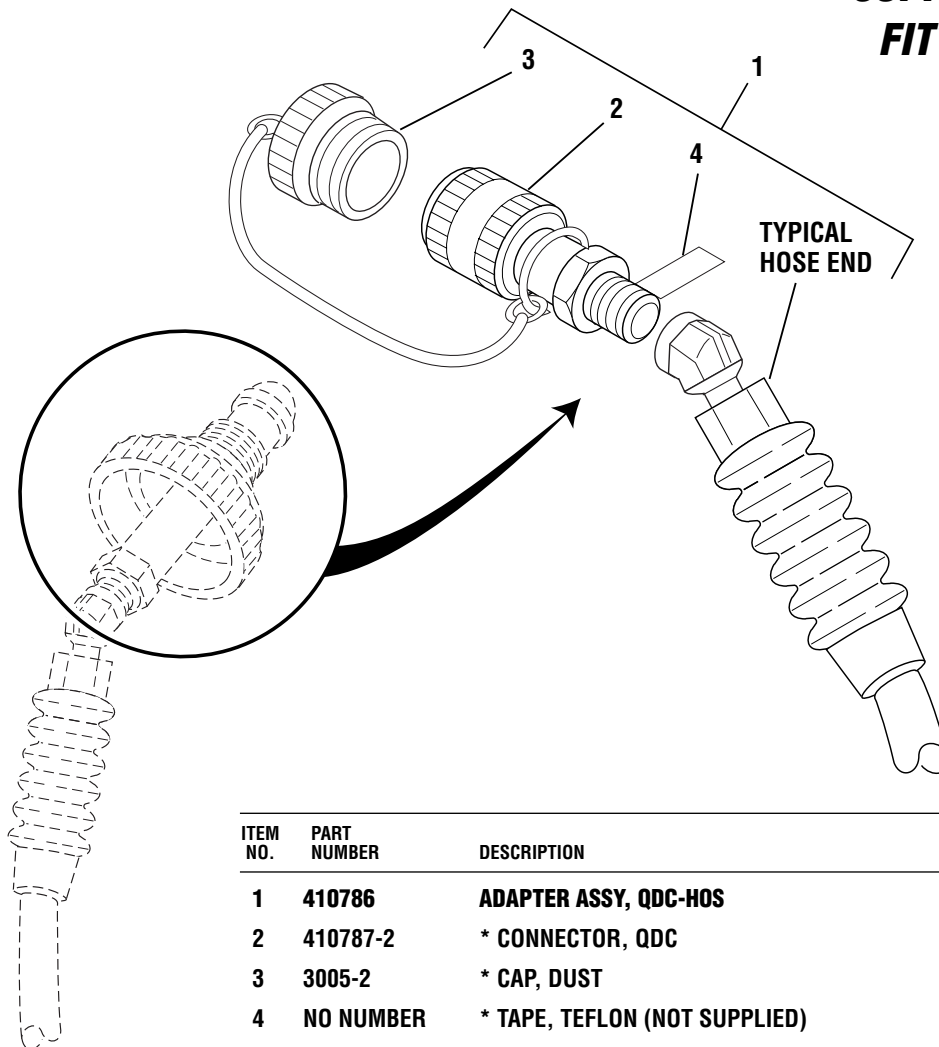

ITEM NO.	PART NUMBER	DESCRIPTION	QTY ASSY
1	410786	ADAPTER ASSY, QDC-HOS	REF
2	410787-2	* CONNECTOR, QDC	1
3	3005-2	* CAP, DUST	1
4	NO NUMBER	* TAPE, TEFLON (NOT SUPPLIED)	AR

QDC-HOS-01282008



QDC-HOSE ADAPTER ASSEMBLY (Part Number: 410786)

CONVERSION GUIDE FOR CONVERTING OLD STYLE SYSTEM/SUPPLY HOSE WITH CGA-680 CONNECTION TO NEW STYLE HOSE WITH QDC CONNECTION

REMOVE CGA-680 CONNECTOR

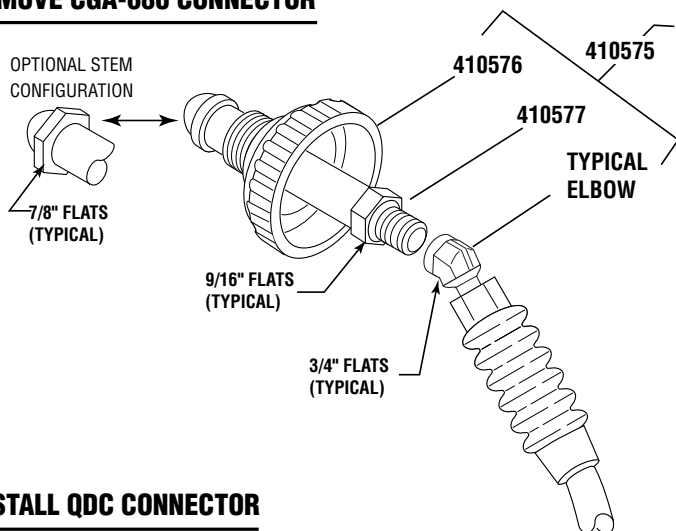

REMOVE CGA COMPONENTS:

- 1.) REMOVE THE CGA-680 CONNECTOR ASSEMBLY (410575) USING A 3/4" OPEN-END WRENCH APPLIED TO THE CONNECTION ELBOW AND A 9/16" OPEN END WRENCH APPLIED TO THE CONNECTOR'S STEM (410577) AND TURNING COUNTER-CLOCKWISE (WRENCHES NOT SUPPLIED).
- 2.) REMOVE THE CONNECTOR ASSEMBLY'S STEM COMPLETELY FROM THE ELBOW. CAUTION: CAREFULLY LOOSEN AND REMOVE WITHOUT DAMAGING THE ELBOW'S THREADS.
- 3.) THOROUGHLY CLEAN AND INSPECT ELBOW THREADS.

SAMPLING OF TYPICAL CGA-680 HOSE ENDS

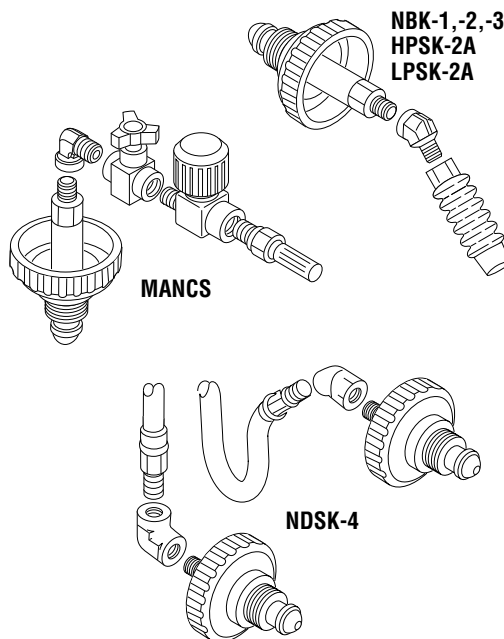

INSTALL QDC CONNECTOR

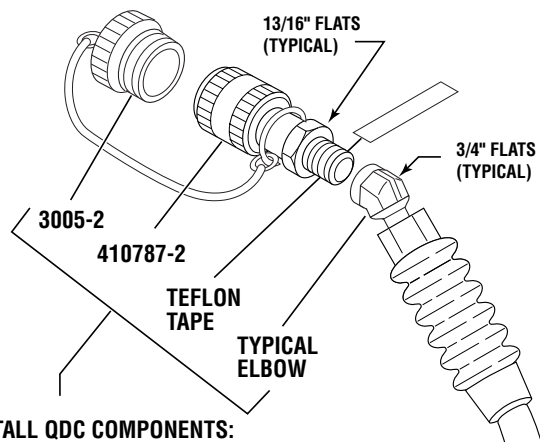

INSTALL QDC COMPONENTS:

- 1.) ENSURE THE CAP'S CHAIN (3005-2) RING IS INSTALLED ONTO THE QDC'S BODY. WRAP SEVERAL WINDS OF TEFLON TAPE AROUND THE THREADS ON THE QDC CONNECTOR (410787-2). USING A 3/4" OPEN-END WRENCH ON THE CONNECTION ELBOW, THREAD THE QDC CONNECTOR THREADS INTO THE ELBOW AND TIGHTEN, USING A 13/16" OPEN-END WRENCH APPLIED TO THE QDC CONNECTOR (WRENCHES NOT SUPPLIED). CAUTION: USE CARE WHEN INSTALLING TO AVOID DAMAGING THREADS.
- 2.) TIGHTEN THE CONNECTION TO ENSUREING A TIGHT, LEAK-FREE CONNECTION.
- 3.) PERFORM A HIGH PRESSURE TEST FOR LEAKS.

NOTE:

ALL CONVERSION AND MODIFICATIONS OF THESE HIGH PRESSURE COMPONENTS MUST BE PERFORMED BY QUALIFIED HIGH PRESSURE PNEUMATIC TECHNICIAN ONLY.